

FFP2 NR D Respirator Series DODO

Main Features

The DODO series filter masks provide effective respiratory protection in industries where workers are exposed to fine dust particles.

- Tested and approved with CE mark according to EN 149:2001+A1:2009
- Flat design enables space-saving storage of the product
- The flat shaped front increases form stability of the mask
- Effective in warm and humid environments
- Produced from 4 light weight filter layers
- Ear loops allow effortless adjustment to face and head
- Nose clip for optimal fit

Material

The following materials are used to manufacture this product:

- Ear loops: thermoplastic elastomer
- Nose clip: steel/plastic
- Filter: polypropylene
- Product weight: 4 g

The products do not contain any components made of natural rubber. It is possible that the material will smell after unpacking. This is normal and the smell will go away after a few minutes.

Standards

The products meet the requirements of European Standard EN 149:2001+A1:2009, filtering half masks for protection against particles. Performance tests in this standard include filter permeability, flammability, breathing resistance and total inward leakage. A full copy of EN 149:2001+A1:2009 can be obtained from your national standards authority. In addition, the products have been subjected to a load test according to EN 1327 4-7 (test method with paraffin oil). In addition, the mask complies with the regulation EU 2016/425. The mask meets the requirements of the dolomite dust retention test.

Permits

The certification was carried out by Geptest, Budapest, notifying body with the identification number 2233.

Usage

DODO filter masks can be used in many industries where workers are exposed to fine dust particles and/or non-volatile liquid substances. The respirators are suitable for use with solid and non-volatile liquid particles up to the following concentrations: 10 times the limiting value. The respirator is only effective if it is properly selected, fitted and worn for the entire time the wearer is exposed to a hazardous substance.

Application examples for FFP2 masks

- Drilling work
- Wood processing
- Quarry work
- Agricultural work
- Sanding/Milling
- Cleaning
- Pest control (water-based)
- Construction work
- Demolition work
- Concreting
- Working with artificial mineral fibers (e.g. insulation material)
- Facility and equipment maintenance
- Silo work
- Pandemic preparation

This selection of examples serves only as an overview of typical areas of application. It must not be used as the sole basis for the selection of the most suitable personal protective equipment as that always depends on the situation and must only be made by a competent person. The person needs to be familiar with the particular risks of the particular working conditions. For more information on performance features and limitations, see the product packaging. In case of doubt, please contact the relevant department or your safety inspector.

Storage and Transport

The expiry date is indicated on the product packaging. Please always check the expiry date before usage to make sure the product is still usable. The product should be stored clean and dry in a temperature between 5 °C and +25 °C at a maximum humidity of 60 %. The product should be transported in its original packaging. For storage, please use the original packaging and do not expose the products to direct sunlight.

Disposal

For the disposal of used respirators, please follow your regional disposal regulations.

Packaging

- 1 mask per foil bag
- 20 bags per box





Mounting instructions

Wash hands before putting on the mask.

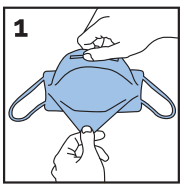

Locate which side of the mask is up and which is down.

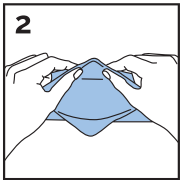

Put on the protective mask and squeeze the metal strip of the mask under your nasal bone so that it follows the shape of your nose.

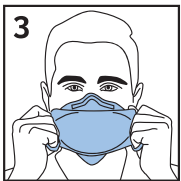

Pull the bottom of the mask down a little so that both mouth and chin are covered.

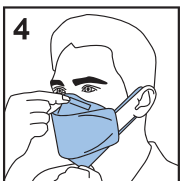

Check the fit of the mask for any drawing of air from the side. Check for any air leakage due to facial hair. If necessary, adjust the fit until the mask sits tightly on your face.

The DODO respirator is for single use only. Please refrain from using the mask when moist, visibly contaminated or if the mask does not fit properly, instead replace the mask with a new, dry and properly fitting one. Do not use the same mask twice.

Shelf life of the product: 3 years when stored and transported properly. Failure to follow these instructions or incorrect use can reduce the effectiveness of the mask and/or cause illness or permanent damage to the health.

Checking for a tight fit

1. Enclose the mask at the front with both hands, without letting it slip.
2. **Breathe out forcefully.**
3. If you notice an air leak at the nose, the nose clip must be pressed harder against your nose. Repeat steps 1 and 2 to make sure the mask sits tightly.
4. If air escapes from the side of the mask, pull on the ear straps until they are tight enough to stop the air flow.

Repeat those steps until no air can escape from under the mask. **Do not enter a hazardous zone before you make sure that your mask is sitting tightly on your face.**

Warning

Always make sure that the respiratory mask meets the following requirements:

- It has to be suitable for the application
- It has to fit correctly
- It has to be worn during the entire exposure period.
- It has to be exchanged when necessary

Proper selection, training, use and appropriate maintenance are required in order for the product to protect the wearer from airborne pollutants. If the instructions for use of the respirators are not properly followed and/or the product is not worn for the full-time during exposure to pollutants, this may result in harmful consequences for the wearers health, up to disability. Refer to applicable local regulations and manufacturer's instructions for suitability and proper use of respirators or consult a safety professional. Before usage, the wearer must first be instructed in the correct handling of the product, in accordance with current health and safety regulations. These products do not protect the wearer from gases and vapors. Do not use the product in environments containing less than 19.5% oxygen. (Individual countries may have their own guideline values for oxygen deficiency. If in doubt, consult a competent person.) Do not use the mask if the concentration of pollutants poses an immediate danger to life and health. Facial hair in the mask area can prove to be a hindrance to the fit of the mask and compromise the seal.

Leave the workplace immediately if:

- a) you experience difficulties breathing
- b) you experience dizziness or other discomfort

Replace and dispose of respirator if damaged, if breathing resistance is high and at the end of a shift. The mask may not be altered or repaired. Please contact the producer if you plan to use the mask in potentially explosive areas.

PPE Germany

Manufacturer:

PPE Germany GmbH
Karlsruher Str. 18, 10711 Berlin
maske@ppegermany.de

Made in Germany
Model: DODO
22.12.2022

CE
2233



EAN: 4 270001 576194